

# WOW! A Golden Age Wonder Woman

## POSABLE MODEL CHARACTER TOY of YOUR VERY OWN!



BASED ON THE CHARACTERS AND STORIES  
CREATED BY **Charles Moulton**

DESIGNED, DRAWN AND COLORED BY THE PROFESSOR

Wow! A paper "Wonder Woman" action figure of your very own! How cool is that? It's a brand new model by the Professor. I hope you'll think it's "wonderful!" It looks just like Diana Prince, alias "Princess Diana of the Amazons," Golden Age Comic heroine from the late 1930s and early 1940s. This model is for entertainment purposes only, and it must not be used commercially in any way!!! Now that the legal stuff is out of the way, get your tools ready, and let's get started!

**STEP ONE:** Study all the text instructions and building diagrams, and test fit parts before gluing together. Cut parts out along the dark colored outlines, and use a scoring tool like an empty ballpoint pen, or a dull old butter knife. This will help create clean, sharp, folds. Most of all, take your time and have fun!

**STEP TWO:** First, we will build the arms and legs of our paper superhero. Roll pieces 1-8 around a pencil or other cylindrical shaped object to get the proper curl. Glue them together to form tapered tubes. To use the folding spring joints, cut and fold the tabs into the center and glue the tube ends closed. If you are planning to string your model together with yarn, or make it posable with wire or pipe cleaners, you will need to punch holes in the flaps at the ends of each tube before gluing them closed. Then, either fold up all of the spring joints, 9-16, and attach them to the tubes following the instruction diagrams on page 2, or roll up the beads on page 3, and "string up" the pieces, with a bead at each joint.

**STEP THREE:** Next, fold up the torso assembly 17. Begin with the tapered hips

section, then the more complex shape of the chest. To string or wire the limbs, you will need to punch holes at the shoulder and hips and run the wires through before closing off the assembly. Reinforce the areas around the holes with thin cardboard. To make the head turn, don't close up the shoulder flap yet. Wrap the belt 18 around the waist and glue in place. Do the same with skirt and liner 19-20 (optional).

**STEP FOUR:** Next, roll up Diana's head 21, and glue down the top flap. If you want the head to turn, you can create a neck pin (see special instructions below & diagram on pg. 3).

**STEP FIVE:** Now assemble the feet units 22-23 and glue them to the ends of the shin units. Then fold up the hands 24-25 and glue them to the ends of the arm units. Wrap the bracelets 26-27, around the wrists and glue them in place.

**STEP SIX:** If you are using the spring joints, attach them to the ends of the arm and leg assemblies and glue them to the torso at the shoulders and pelvis. If you are using string or wire, see the special instructions below and the diagram on pg. 3 before moving on.

**STEP SEVEN:** The last step is to glue the hair pieces 28-29 together. Wrap and glue the diadem 30 around head. Finally, fold and glue the golden lasso 31, loop part 31 around the lasso and glue to her belt and "voilà!" - she's ready!

**SPECIAL INSTRUCTIONS:** If you decide to use string or wire to hold your model together, I suggest you strengthen the model by rolling strips of paper around a toothpick and inserting them into the arm and leg tubes before gluing them shut. This will make them "solid" while still leaving a hole to pass the string or wire through. The head can be made solid in a similar fashion, and if the paper strips are wrapped around a pencil, a large enough hole will be left to allow an axle of paper to be rolled up, inserted into the head, passed through the shoulder plate, and fixed in place with a thin strip wrapped around the end (see pg.3).

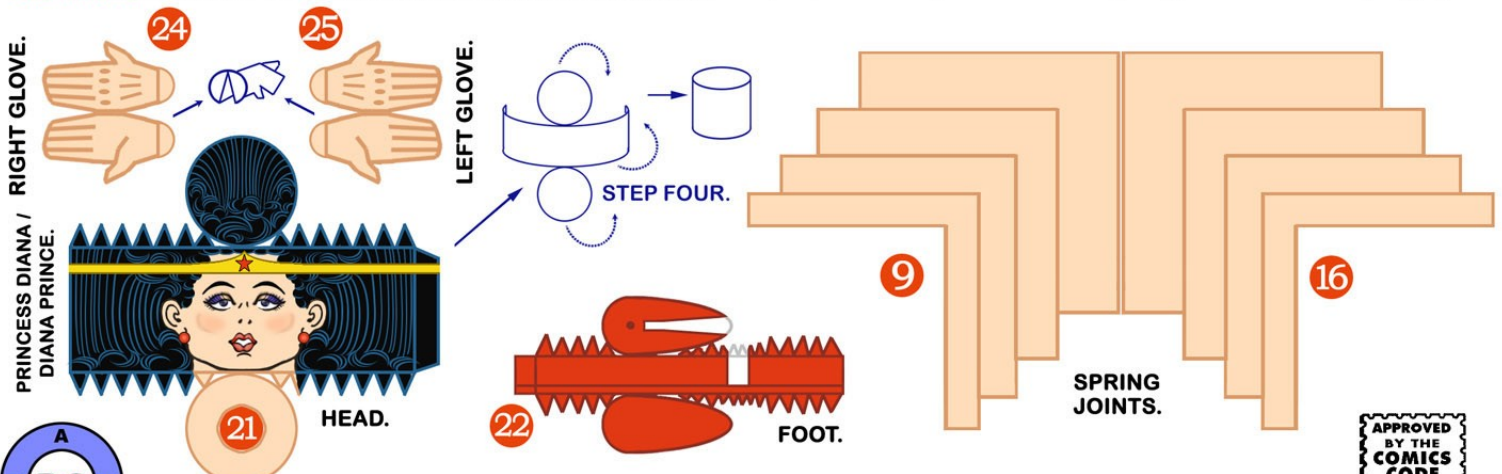

INSPIRED BY THE EXCELLENT WORKS OF CHARLES MOULTON AND CHRIS WARE  
"Wonder Woman" character and the distinctive likeness(es) thereof are Trademarked & Copyrighted by DC Comics, Inc. ALL RIGHTS RESERVED.



ARM PIECES.

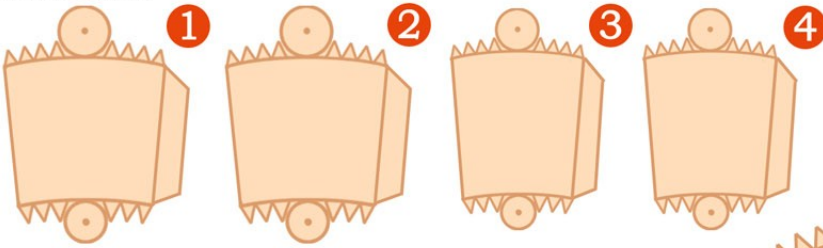

FOOT.

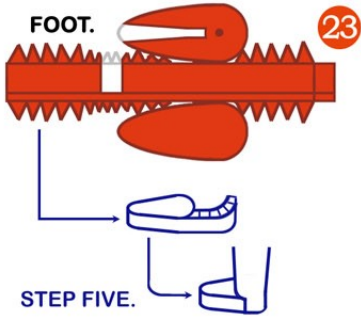

CHEST ASSEMBLY.

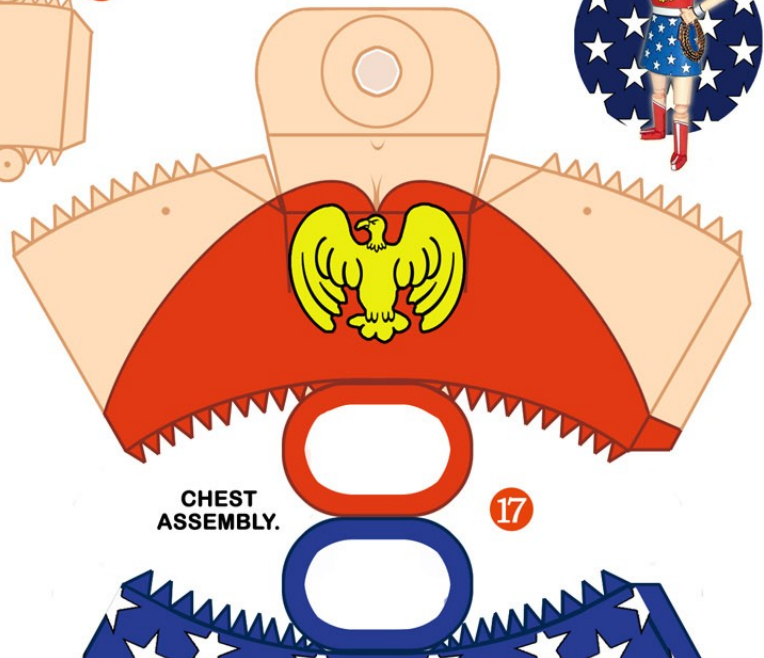

BELT.

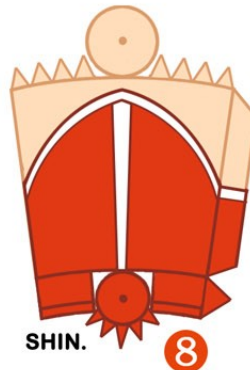
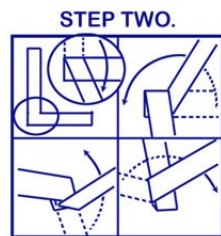
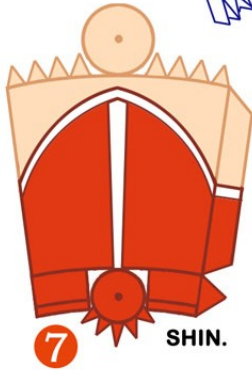
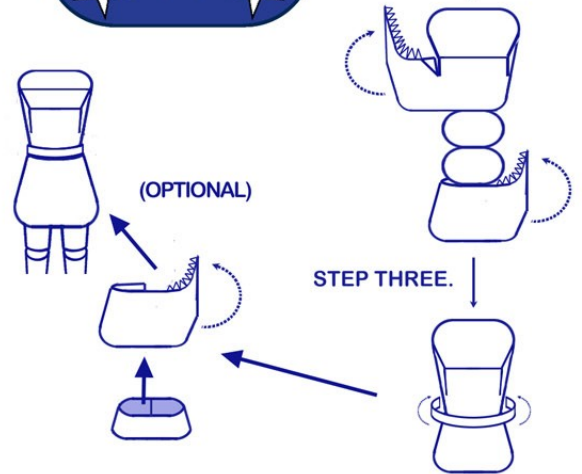
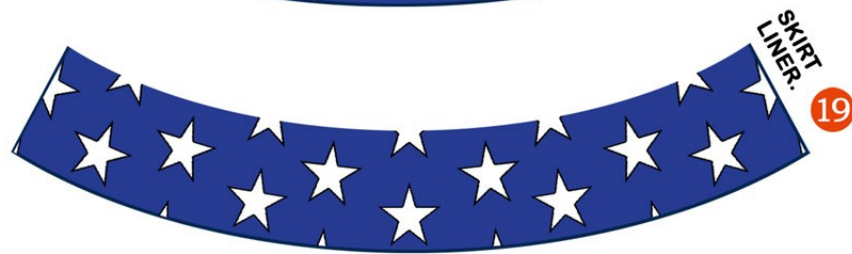
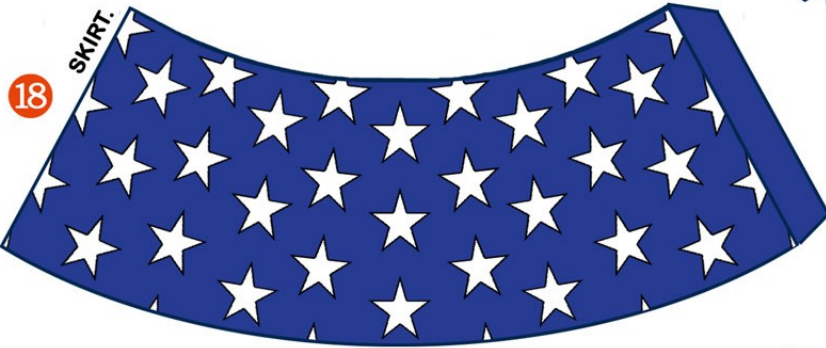
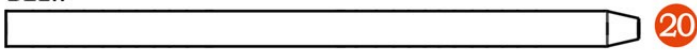



A base for your figure.



DIADEM.



HAIR.

HAIR INSIDE.



BELT LOOP.

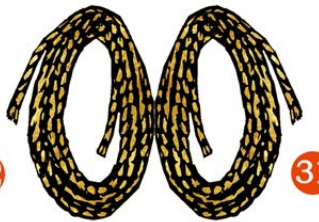

GOLDEN LASSO.

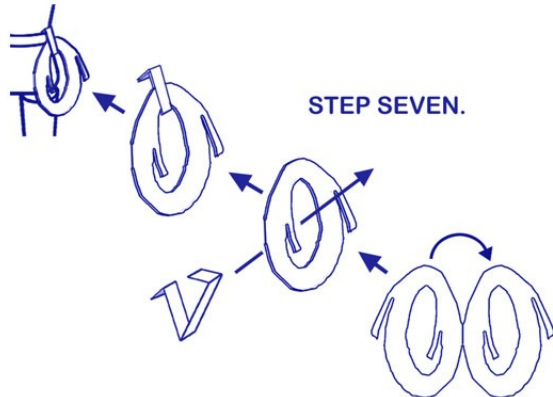
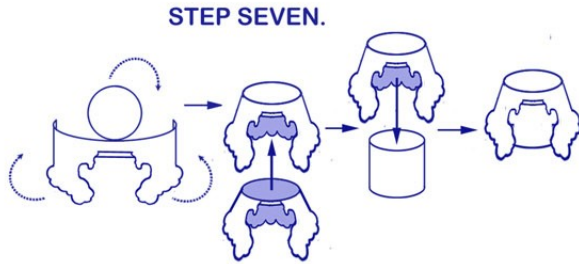
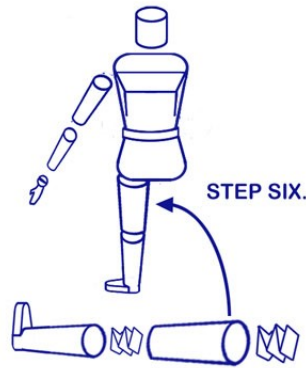

SHORTS OPTION.



DETAIL SHOWING HOW TO RUN WIRE OR YARN THRU THE ARM & LEG PIECES; ALSO, THE NECK PIN AND "NUT" TO HOLD IT IN PLACE.

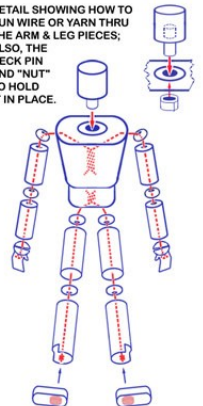

SMALL, STRONG MAGNETS IN THE FEET WILL HELP FIGURE STAND. (ON METAL SURFACES OF COURSE!)

Roll these triangles up around a toothpick from thick end to point and glue down to create beads to use at joints.

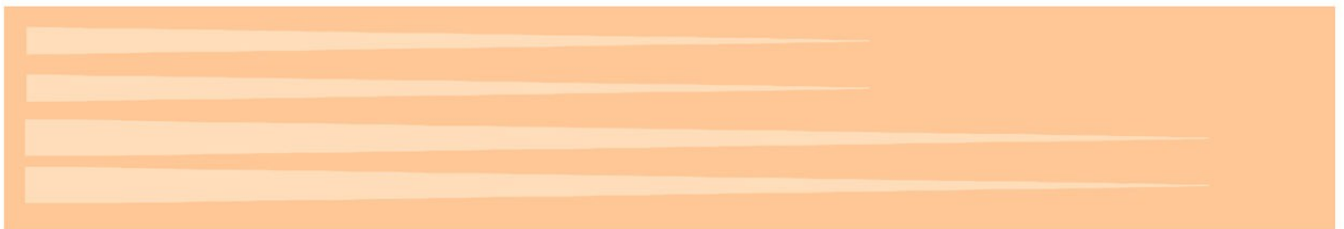

These beads are designed to be used in place of the spring joints when assembling the figure using pipe cleaners, string or yarn. Punch holes in the ends of each leg and arm cylinder and into the torso, then run the pipe cleaners, string or wire through, inserting a bead in between them at the shoulders, elbows, hips and knees. Twist or tie them off inside the torso and at the ends of the limbs, hiding the ends in the hands and feet. Use the pieces above for the shoulders and elbows; the ones at left for the hips, and below for the knees.

