

WOW! A Golden Age

THE HUMAN TORCH



BASED ON THE CHARACTERS AND STORIES
CREATED BY *Carl Burgos*

POSABLE MODEL CHARACTER TOY
of YOUR VERY OWN!

DESIGNED BY THE PROFESSOR ON CHRIS WARE'S TEMPLATE

Wow! A paper "Human Torch" figure of your very own! What could be hotter? It's a new model based on artist Chris Ware's fun toy. I hope you think it's "smokin'!" It looks just like Ol' Torchy, "The Fightin' Fireball" during the Golden Age of Comics in the late 1930s and early 1940s. This model is for entertainment purposes only, and it must not be used commercially in any way!!! Now that the legal stuff is out of the way, get your tools ready, and let's get started!

STEP ONE: Study all the text instructions and building diagrams, and test fit parts before gluing together. Cut parts out along the dark colored outlines, and use a scoring tool like an empty ballpoint pen, or a dull old butter knife. This will help create clean, sharp, folds. Most of all, take your time and have fun!

STEP TWO: First, we will build the arms and legs of our paper superhero. Roll pieces 1-8 around a pencil or other cylindrical object to get the proper curl. Next, glue them together to form tubes. To use the spring joints, simply cut and fold the tabs into the center and glue the ends closed. If you are planning to string your model together with yarn, or make it posable with wire or pipe cleaners, you will need to punch holes in the flaps at the ends of each tube before gluing them closed. Then, either fold up all of the spring joints, 9-16, and attach them to the tubes following the instruction diagrams on page 2, or roll up the beads on page 3, and "string up" the pieces, with a bead at each joint.

STEP THREE: Next, fold up the torso assembly 17. Begin by making the "sardine



can" shape of the hips, then the tapered shape of the chest. To string or wire the limbs, punch holes at the shoulder and hips, then run the wires or strings through before closing off the assembly. Reinforce the areas around the holes with thin cardboard. To make the head turn, don't close up the shoulder flap just yet. Glue the shoulder flames backing 18 in place.

STEP FOUR: Next, roll up Torchy's head 19, and glue down the top flap. (To make head turn, see special instructions below & diagram on pg. 3.) Fold and glue down head flame 20.

STEP FIVE: Now, assemble the "sardine can" feet 21-22, and glue them to the ends of the shin units. The flames should run along the top edges of the feet. Then, fold up the hand pieces 23-24 and glue them down to the ends of the arm assemblies.

STEP SIX: If you are using the spring joints, attach them to the ends of the arm and leg assemblies and glue them to the torso at the shoulders and pelvis. If you are using string or wire, see the special instructions below and the diagram on pg. 3 before moving on.

STEP SEVEN: The last step is to fold up the fireball pieces 25-26. Cut slits along the red lines and slide the pieces together. Torchy can hold them in his palms or you can slide them onto the ends of his hands. *He's on fire!*

SPECIAL INSTRUCTIONS: If you decide to use string or wire to hold your model together, I suggest you strengthen the model by rolling strips of paper around a toothpick and inserting them into the arm and leg tubes before gluing them shut. This will make them "solid" while still leaving a hole to pass the string or wire through. The head can be made solid in a similar fashion, and if the paper strips are wrapped around a pencil, a large enough hole will be left to allow an axle of paper to be rolled up, inserted into the head, passed through the shoulder plate, and fixed in place with a thin strip wrapped around the end (see pg.3).

A Very Special Thanks to Artist Chris Ware for his kind permission to use his template.

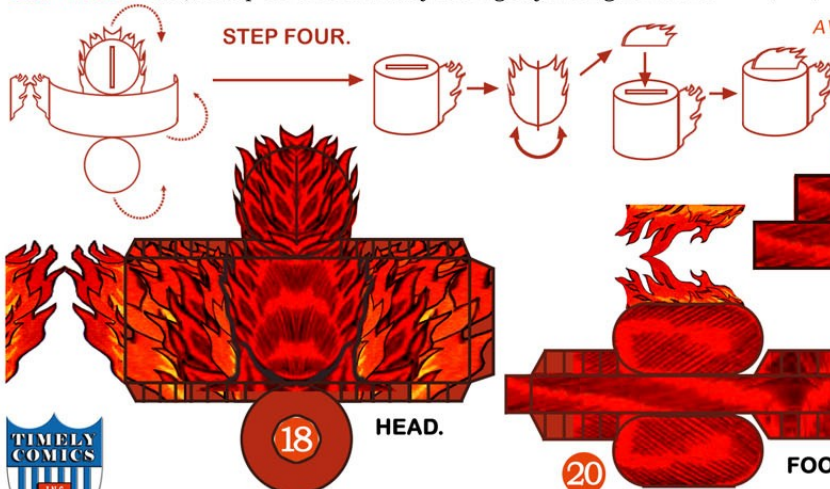

INSPIRED BY THE WORKS OF CARL BURGOS AND CHRIS WARE
"Human Torch" character and the distinctive likeness(es) thereof are Trademarked & Copyrighted by Marvel Comics, Inc. ALL RIGHTS RESERVED.



ARM PIECES.

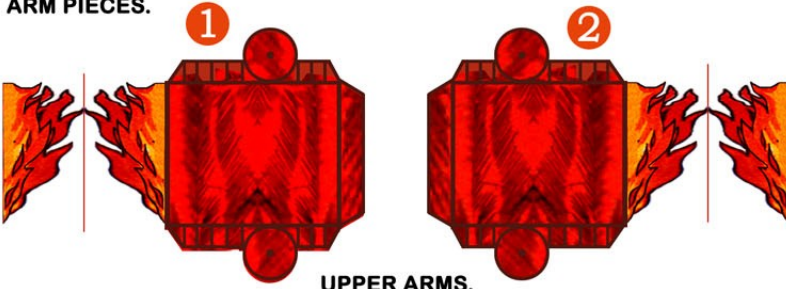

UPPER ARMS.

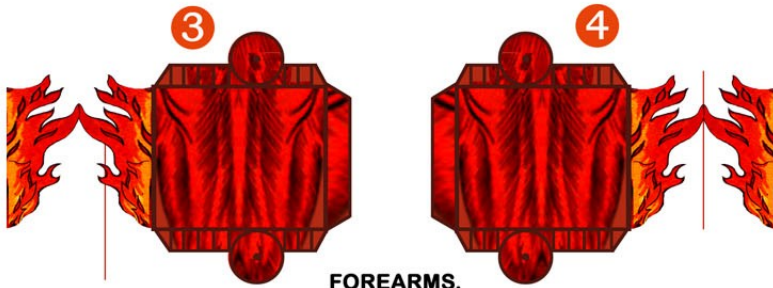

FOREARMS.

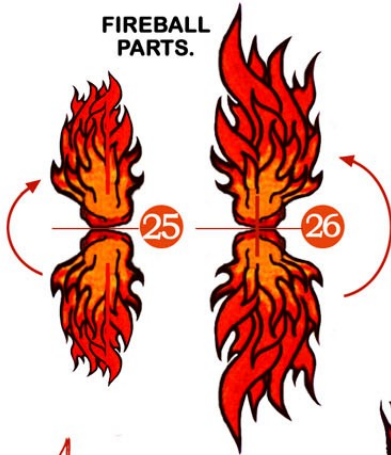

FIREBALL PARTS.

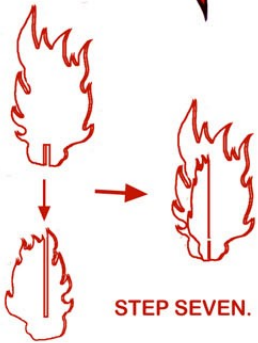

STEP SEVEN.



SHOULDER FIRE BACKING.

STEP TWO.

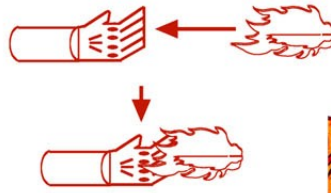

STEP SEVEN.

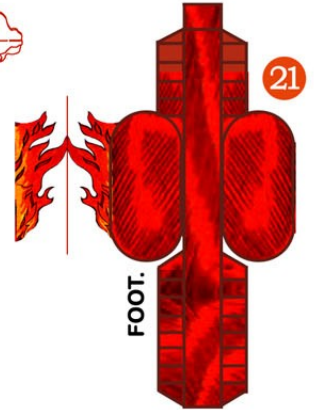

FOOT.

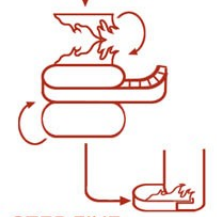

STEP FIVE.

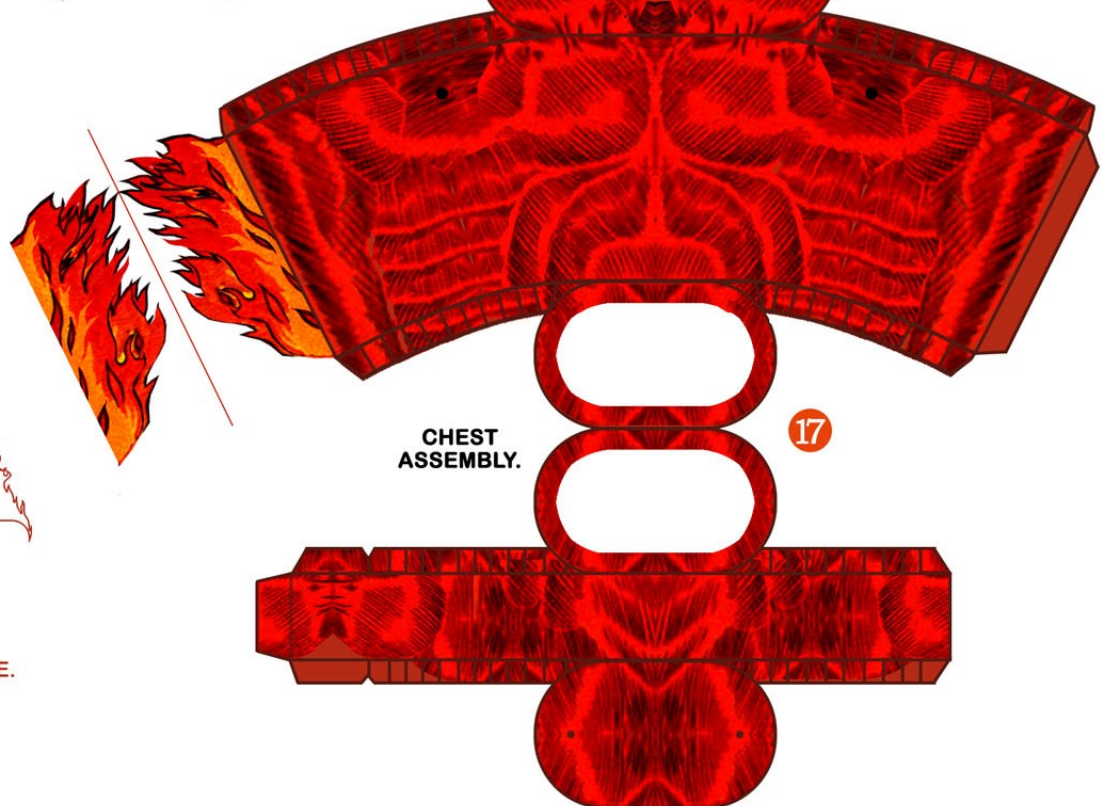

CHEST ASSEMBLY.

17

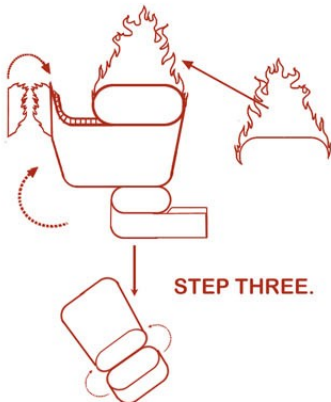

STEP THREE.

THE HUMAN TORCH

A base for your figure.

STEP TWO.

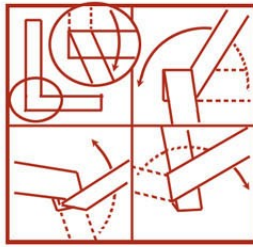

24 RIGHT GLOVE.



23 LEFT GLOVE.



STEP SIX.

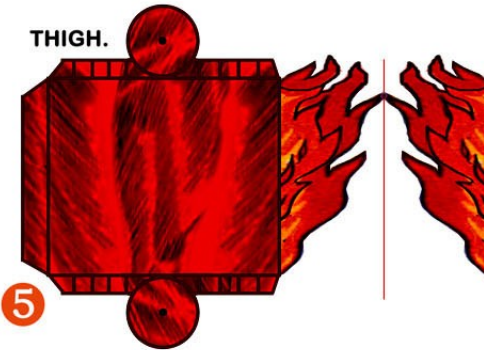
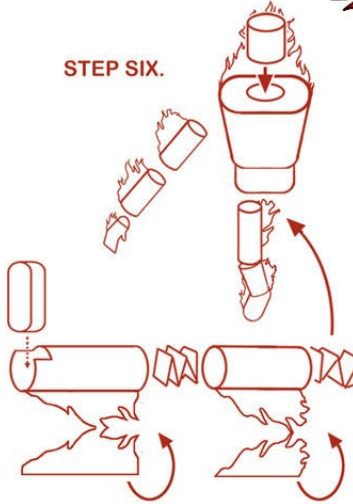

THIGH.

5

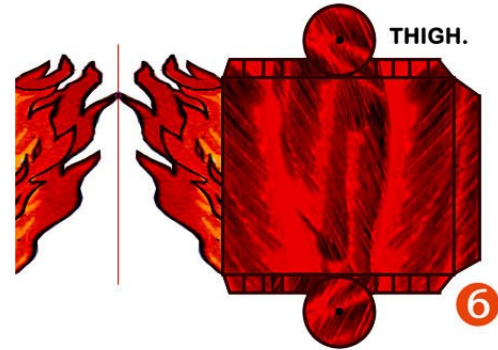

THIGH.

6

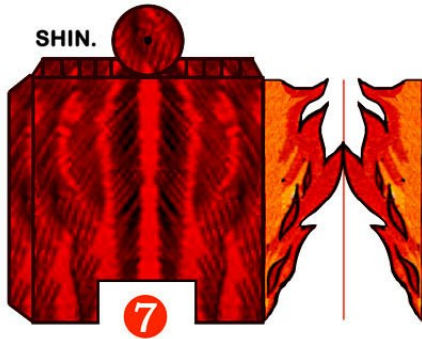

SHIN.

7

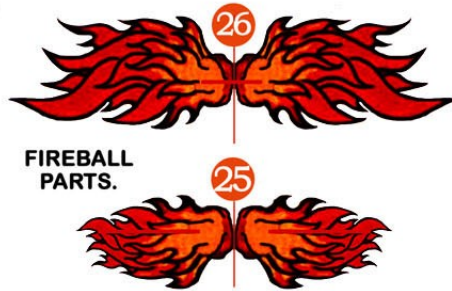

26
FIREBALL PARTS.

25

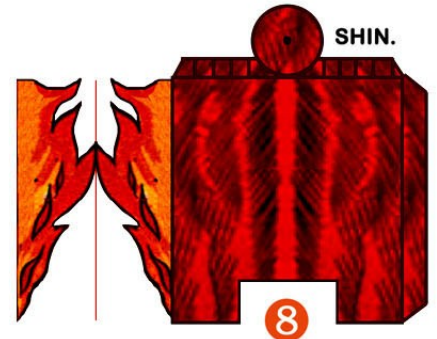

SHIN.

8

Roll these triangles up around a toothpick from thick end to point and glue down to create beads to use at joints.



DETAIL SHOWING HOW TO RUN WIRE OR YARN THRU THE ARM & LEG PIECES; ALSO, THE NECK PIN AND "NUT" TO HOLD IT IN PLACE.

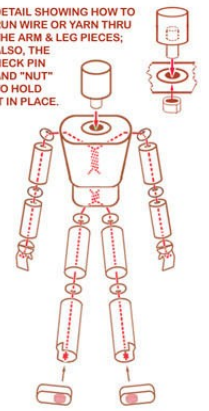

SMALL, STRONG MAGNETS IN THE FEET WILL HELP FIGURE STAND. (ON METAL SURFACES OF COURSE!)

These beads are designed to be used in place of the spring joints when assembling the figure using pipe cleaners, string or yarn. Punch holes in the ends of each leg and arm cylinder and into the torso, then run the pipe cleaners, string or wire through, inserting a bead in between them at the shoulders, elbows, hips and knees. Twist or tie them off inside the torso and at the ends of the limbs, hiding the ends in the hands and feet. Use the pieces above for the shoulders and elbows; the ones below for the hips and knees.

